

Instructions

Installation and Programming

PKF

Mark Door

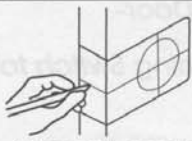

A. Use template provided to mark door for drilling 1044mm(41") from base of the door or 4" above door knob or lever center to center.



B. Use the template to select backset 60mm(2-3/8") or 70mm(2-3/4").

Drilling

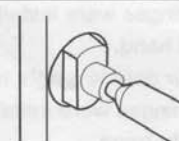

A. Bore 2-1/8"(54mm) hole through door face from both sides of door to avoid damaging door surface.

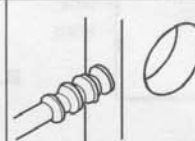

B. Drill 24mm(15/16") to 25mm (1") hole through door edge.

Install Deadbolt

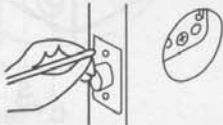

A. Insert deadbolt latch into hole, make the plate all around and the screw hole.



B. Chisel recess for face plate.



A. Secure latch with screws.

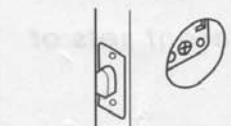

B. Make sure the face plate of the latch is even with edge of door.

Install Door Jamb



A. Shut door and mark door jamb exactly opposite center of bolt hole by tracing hole.

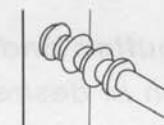

B. Drill an enlarge hole jamb 25mm(1") and 12.7mm (1/2") deep.

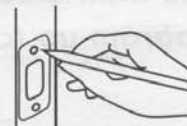

A. Base on mark chisel recess at least 2.5mm(1/10") for strike box.

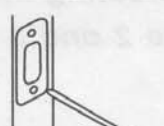

B. Secure strike plate with screws

Deadbolt Latch Must Be Able To Operate Smoothly With Door Jamb, Strike Box, And Strike Plate, After Installation.

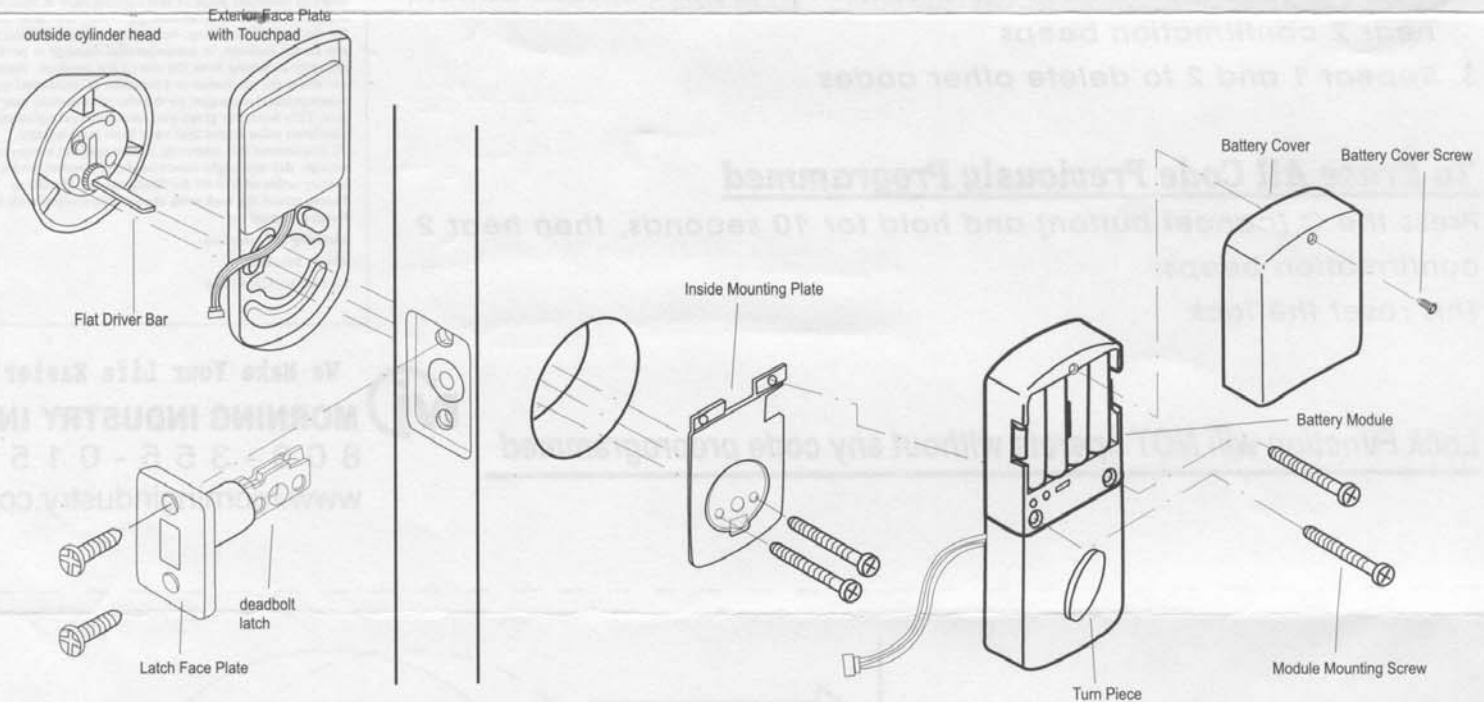

A. Place the latch in an Unlock position. Turn the turn piece to the opposite direction from the door edge in unlock position. Install the outside cylinder head, turn the flat driver bar perpendicular to the ground, insert through cross-hole on the latch, then connect to the turn piece.

B. Secure all the mounting screws then test for a smooth operations, if jam, readjust procedure A to ensure a complete smooth operation.

CA Technology Inc.
www.ca-tec.com