

1. Front plate (key override option shown)
2. Back plate (hold-open models have a sliding snib)
3. Escutcheon plate for 161 cut out
4. Spring loaded spindle
5. Latch (60mm, 70mm backset)
6. Strike plate
7. Wood screws x 4
Use with latch & strike plate
8. Latch support post
9. Tweezers (for changing the code)
10. Fixing bolts 3 supplied (spare x1)
11. Code tumblers (spare x 2)
12. Code card
13. 2 keys - key override models only

Tools required for installation

- Power drill
- 25mm, 13mm & 8mm drill bits
- Bradawl
- Philips screwdriver size 2
- Chisel (maximum 25mm)
- Hammer/Mallet
- Stanley knife
- Adhesive tape
- Pencil
- Tape measure

SPECIAL NOTES

You are advised to familiarise yourself with the instructions before starting work.

- The 'hold-open' model is equipped with a snib on the backplate. This enables the latchbolt to be held open when required.
- Before commencing installation check that all parts are working correctly — press the code according to the code card and then the knob should turn and return easily under spring pressure. If you have a key override lock try the keys to ensure that they turn in the knob handle.
- If you intend to change the code, you should do it, if it is convenient, before installing the lock — see the code change instructions in the separate leaflet.
- Make sure that the lever handle of the backplate moves freely. If your lock is a 'hold-open' model then check that the snib will engage and hold the handle in the 'latch-open' position.
- Check that the latch bolt moves freely by pressing at the end and also by turning the flat spindle in the latch cam.

1 CHECK THE HAND OF YOUR DOOR

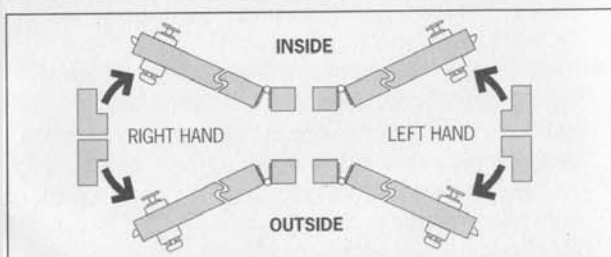

Viewed from outside, a door is right handed if the hinges are on the right, and left handed if the hinges are on the left.

2 APPLY THE TEMPLATE

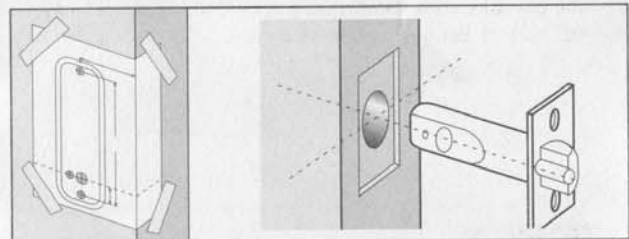

- Crease the template along the line marked Door Edge, and tape it to the door.
- Mark the 13mm hole and the 3 x 8mm holes. Mark the centre line of latch in the middle of the door edge. Now apply the template to the other side of the door, aligning it with your first mark in the middle of the door edge. Mark the 4 holes again.
- Keeping the drill level and square to the door, drill holes from both sides to avoid splintering out of door face.

Positioning and fixing the latch

- Mark a central point on the 'centre line of latch' on the door edge.
- Mark the depth of 85mm on the drill bit with tape to act as a visible depth limit. Drill a 25mm hole, 85mm deep, keeping the drill level and square to the door.
- Insert the latch into the hole, and with the edges parallel to the door, draw around the face plate.
- Remove the latch. Score the pencil line with a Stanley Knife to avoid splitting prior to chiselling. Chisel a 3mm rebate to fit the latch face flush to the door edge.
- Fix the latch with the wood screws, with the bevel towards the door frame.